

**1 Site Plan**  
1 : 5000

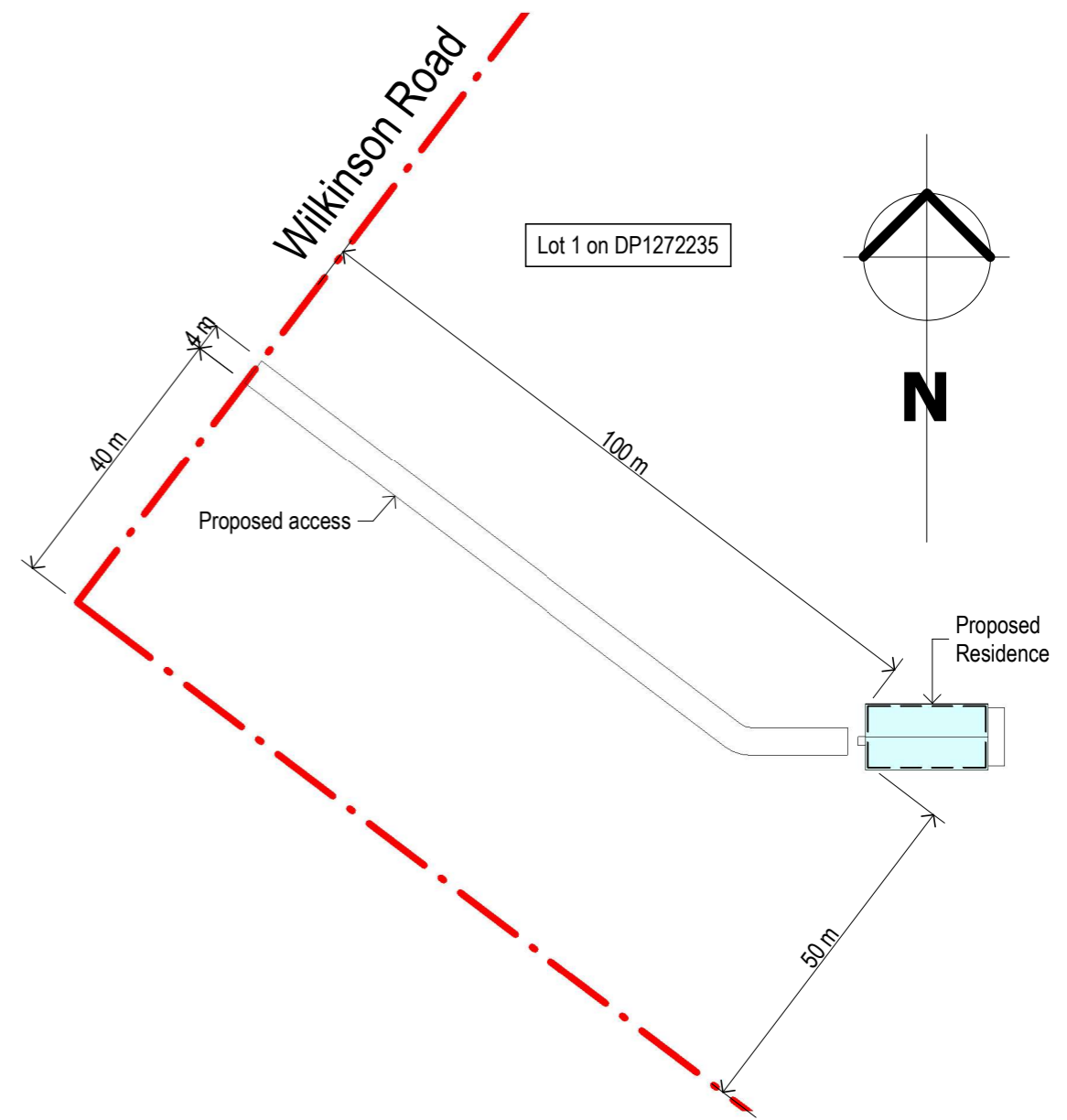

**2 Site Plan (Detailed)**  
1 : 1000

**NOTES:**

- All dimensions are in millimetres unless noted otherwise.  
All levels and site conditions are to be confirmed on site prior to the ordering of materials or commencement of construction.
- All work is to be carried out in accordance with the National Construction Code (NCC), the relevant Australian design standards and **BASIX Certificate No.: 1226005S**.  
All timber framework to AS1684.  
All concrete slabs and footings to AS2870 and Engineer's specification.

**Drawing Schedule**

Drawing No.	Title	Issue	Issue Type	Issue Date
WD-01	Site Plan, Notes & Schedules	C	Client Issue	25/08/2021
WD-02	Floor Plan & Schedules	C	Client Issue	25/08/2021
WD-03	Elevations	C	Client Issue	25/08/2021
WD-04	Typical Section	C	Client Issue	25/08/2021
WD-05	BASIX Details	C	Client Issue	25/08/2021
WD-06	3D Views	C	Client Issue	25/08/2021



**Marshall Drafting Services**

PO Box 4219  
Armidale NSW 2350  
M: 0438 770 279  
T: (02) 6771 1603  
E: marshalldrafting@gmail.com

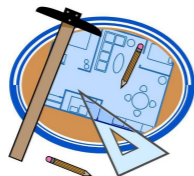

THE BUILDER IS TO LOCATE ALL EXISTING SERVICES AND VERIFY LEVELS AND DIMENSIONS ON SITE BEFORE COMMENCING ANY EXCAVATION OR BUILDING WORKS.

THE BUILDING WORKS WILL COMPLY WITH THE RELEVANT SECTIONS OF THE NATIONAL CONSTRUCTION CODE AND BE CONSTRUCTED IN ACCORDANCE WITH THE WORKING DRAWINGS, THE ENGINEER'S DRAWINGS AND SPECIFICATIONS.

THIS DOCUMENT IS SUBJECT TO COPYRIGHT AND REMAINS THE PROPERTY OF MARSHALL DRAFTING SERVICES - ABN 15 678 662 718

B & L. Stephenson

**Proposed Residence at**

"Woodfield - Whispering Cottage"  
9541 New England Highway  
Arding NSW 2358

**Site Plan, Notes & Schedules**

Project Number	21086	WD-01	C
Date	23/07/2021		
Drawn by	C. Marshall	Scale	As indicated
Checked by	C. Marshall		