

1 Site Analysis Plan

1 : 250

NOTES:

- All dimensions are in millimetres unless noted otherwise.
All levels and site conditions are to be confirmed on site prior to the ordering of materials or commencement of construction.
- All work is to be carried out in accordance with the National Construction Code (NCC), the relevant Australian design standards and **BASIX Certificate No.: 1279214S**.
All timber framework to AS1684.
All concrete slabs and footings to AS2870 and Engineer's specification.

The builder is to comply with the requirements contained in the related Section 88B document pertaining to the required services easements.

'Dwelling Sarking and Mechanical Ventilation installations to be carried out in accordance with BCA Vol 2 Part 3.8.7 – Condensation Management'

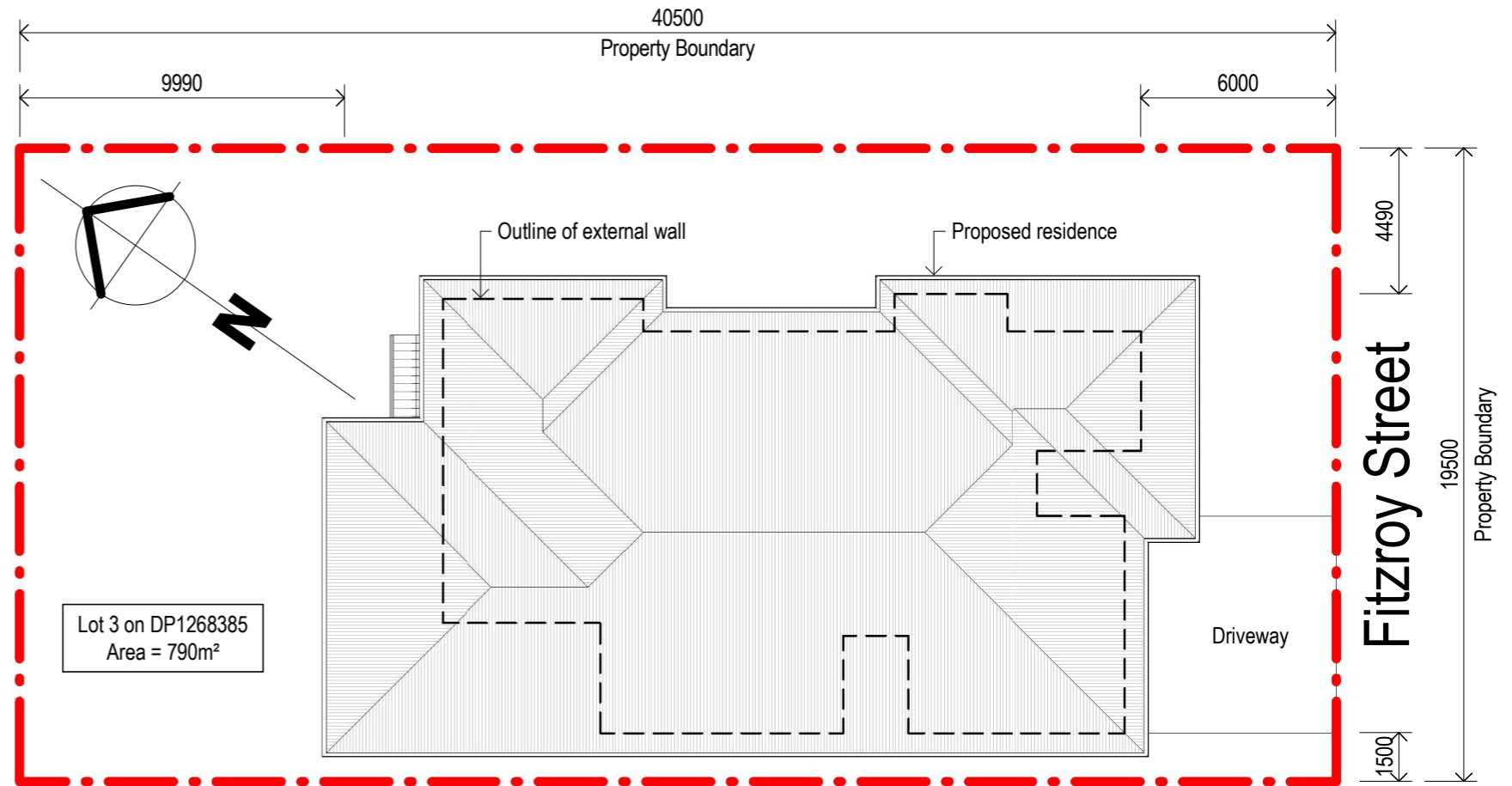

2 Site Plan

1 : 200



MARSHALL
DRAFTING SERVICES

20 Kuranda Avenue
Armidale NSW 2350
M: 0438 770 279

E: marshalldrafting@gmail.com

No.	Description	Date
A	Preliminary Issue	10.02.22
B	Client Issue	26.02.22
C	Client Issue	07.03.22
D	Client Issue	29.04.22

THE BUILDER IS TO LOCATE ALL EXISTING SERVICES AND VERIFY LEVELS AND DIMENSIONS ON SITE BEFORE COMMENCING ANY EXCAVATION OR BUILDING WORKS.

THE BUILDING WORKS WILL COMPLY WITH THE RELEVANT SECTIONS OF THE NATIONAL CONSTRUCTION CODE AND BE CONSTRUCTED IN ACCORDANCE WITH THE WORKING DRAWINGS, THE ENGINEER'S DRAWINGS AND SPECIFICATIONS.

THIS DOCUMENT IS SUBJECT TO COPYRIGHT AND REMAINS THE PROPERTY OF MARSHALL DRAFTING SERVICES
ABN 15 678 662 718

S. Clark

Proposed residence

31 Fitzroy Street
Uralla NSW 2358

Site Plans & Notes

Project Number	22012	WD-01	D
Date	08/02/2022		
Drawn by	C. Marshall		
Checked by	C. Marshall	Scale	As indicated

Printed on: 29/04/2022 9:18:59 AM