

LOT 10
D.P.285189
58124m2

NOTE:
SCRAPE BUILDING ENVELOPE
DOWN TO LEVEL GROUND

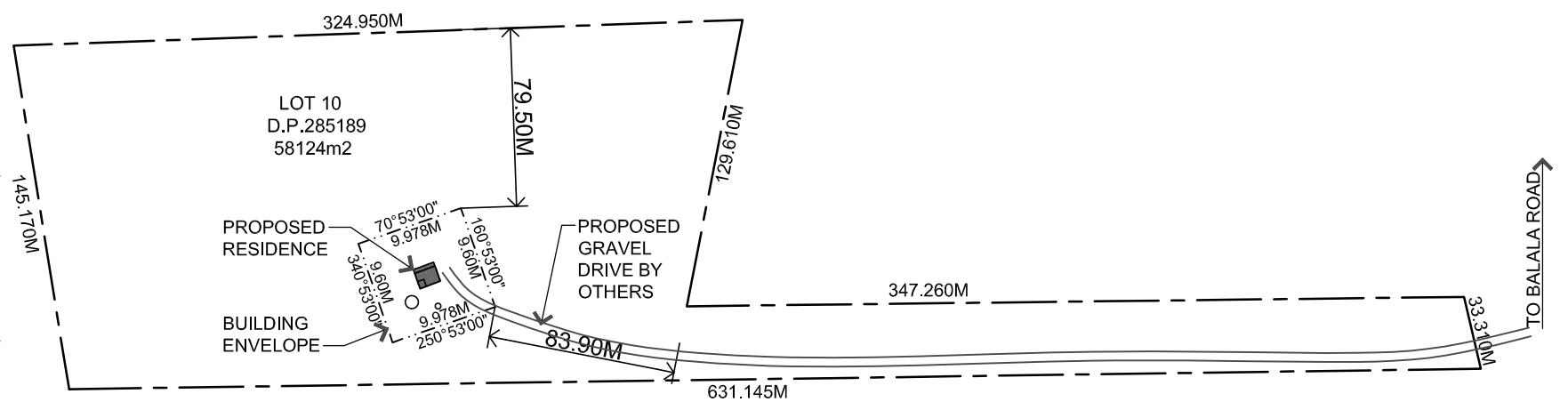

○ SITE PLAN
SCALE: 1:3000 on A3

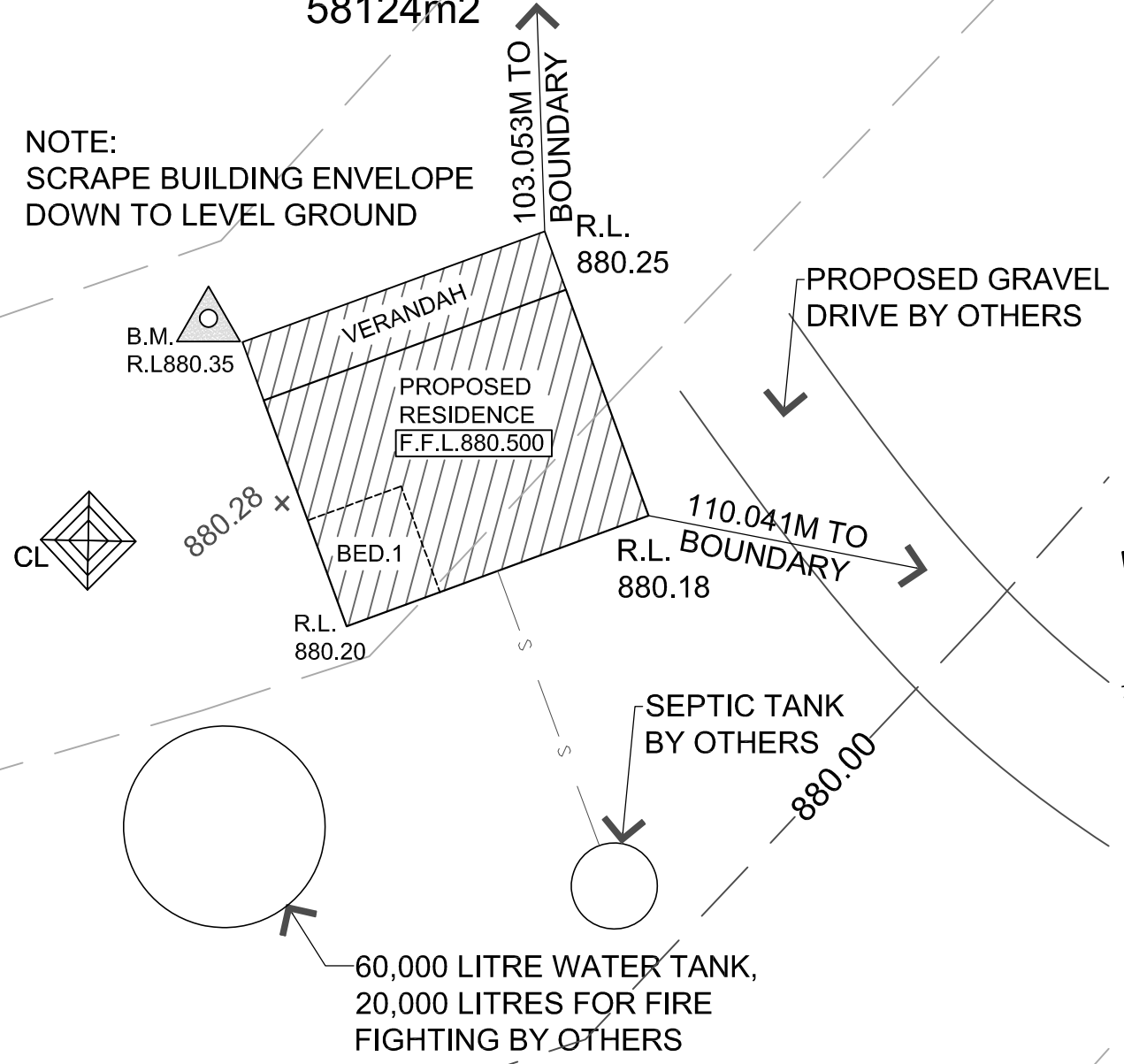
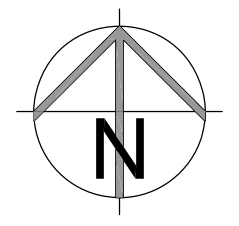

NOTE: ALL SETBACKS FROM BOUNDARIES
TO BE CONFIRMED ON SITE.

○ PART SITE PLAN
SCALE: 1:200 on A3

NOTE: SUBJECT SITE HIS VACANT LAND WITH ESTABLISHED
TREES. BUILDING ENVELOPE TO BE CLEARED OF ANY
OBSTRUCTIONS PRIOR TO COMMENCEMENT OF ANY
BUILDING WORKS.

DESIGNED FOR:	
WIND SPEED LOAD	"N3"
BUSHFIRE ATTACK LEVEL	"BAL-12.5"



PO Box 1563
Armidale NSW 2350
T: 02 6772 1077
M: 0414 782 867 | E: office@crofts surveying.com | www.crofts surveying.com



COUNCIL ISSUE

			DESIGNED AND SUPPLIED BY PAAL Homes Pty Ltd P.O Box 290 Penrith NSW 2751 Ph: (02) 4735 4377 Copyright PAAL Homes 2023	SCALE PRINTED ON DRAWN DATE ISSUE B	1:200,1:3000 on A3 22 - 05 - 2023 JD 10 - 05 - 2023 DRAWING No: 1/6 JOB No: M5994-GF	PROPOSED NEW RESIDENCE FOR: Mr R.McDonald at Lot 10, D.P.285189, No.189 Balala Road, Balala, N.S.W. 2358
B	22/05/2023	COUNCIL ISSUE				
A	10/05/2023	PRELIMINARY ISSUE - NOT FOR COUNCIL SUBMISSION				
REV:	DATE	DESCRIPTION				