

NOTES:
- Existing house to be measured/confirmed

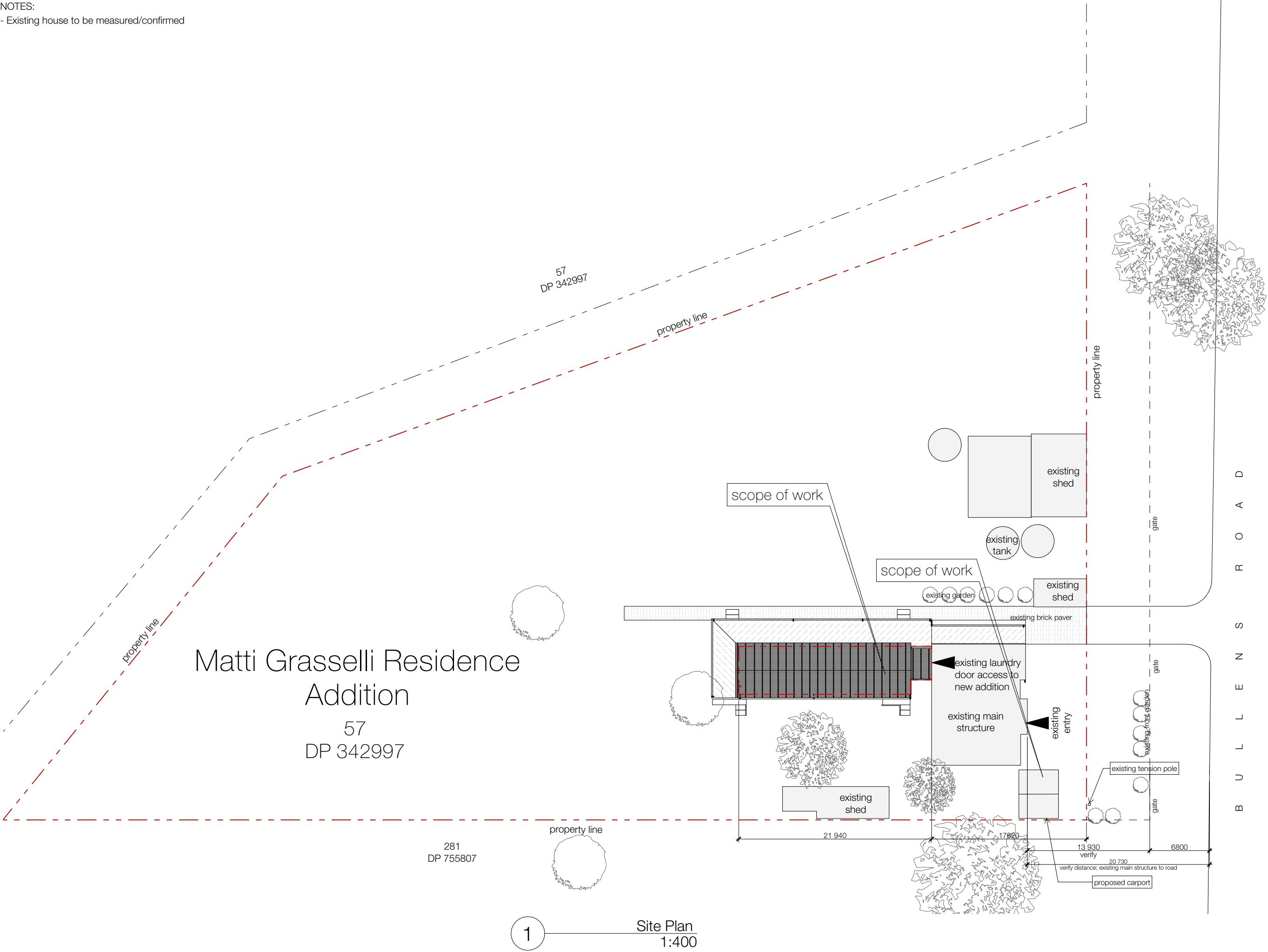

epic.
architecture

THIS DRAWING IS COPYRIGHT.
NO PART OF THE DRAWING MAY BE
REPRODUCED OR USED WITHOUT THE
BUILDING DESIGNERS AUTHORITY.

DO NOT SCALE THIS DRAWING; USE
FIGURED DIMENSIONS ONLY.

DIMENSIONS & LEVELS SHOWN ON THIS
DRAWING ARE TO BE VERIFIED BY
THE CONTRACTOR PRIOR TO THE
COMMENCEMENT OF WORK.

3 cm ACTUAL

IF THE ABOVE DIMENSION DOES NOT
MEASURE THREE CENTIMETERS (3 cm)
EXACTLY, THIS DRAWING WILL HAVE
BEEN ENLARGED OR REDUCED,
AFFECTING ALL LABELED SCALES.

THIS DRAWING MAY NOT
BE TO SCALE

REFER TO GRAPHIC
SCALE BELOW:

1 : 200

1 : 100

NOTES:
THE BUILDER IS RESPONSIBLE FOR VERIFYING ALL
DIMENSIONS, TIMBER SIZES, MATERIAL LISTS, WIND
RATINGS, AND SETOUTS PRIOR TO
COMMENCEMENT OF ANY WORK.

BUILDING WORKS ARE TO BE SET OUT BY A
REGISTERED SURVEYOR.

Grasselli Residence
57 BULLENS ROAD ROCKY RIVER
NSW 2358

F	Revision F	08/08/23
E	Revision E	26/05/23
D	Revision D	21/02/23
C	Revision C	11/10/22
B	Revision B	15/08/22
A	First Submission - client Approval	05/06/22

Matti Grasselli
57 Bullens Road Rocky River
NSW 2358

DEVELOPMENT APPLICATION
SITE PLAN

Member
Australian Institute of Architects
2021

JENA GLOVER
Architect
NSW Reg. 11662

epic.
architecture

Richards Plaza
Suite 4 - 197 Beady Street
Armidale, NSW 2350

(m) 02 6714 9414

(e) jena@epicarchitecture.com.au

(w) www.epicarchitecture.com.au

DRAWN	JG	DATE	9/4/2023
CHECKED	JG	SCALES	
PROJECT NO	220126	DWG NO	D002
		REV	F