

Right End

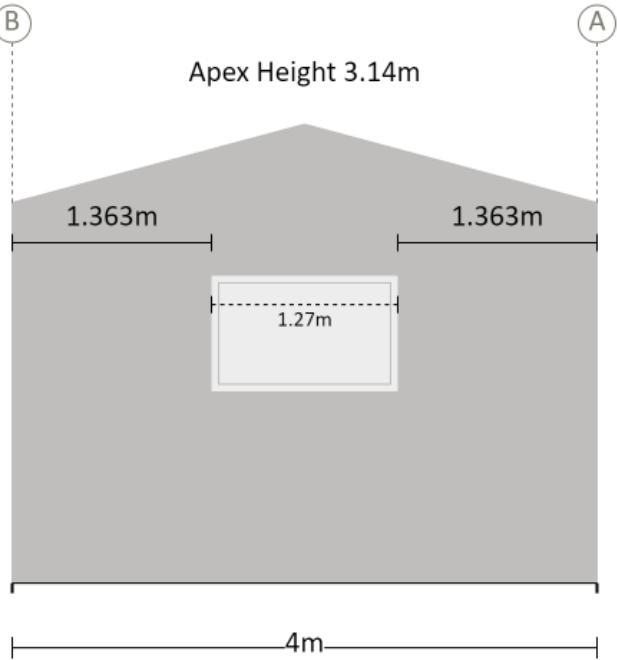

Measurements are from the outside of side girts to the inside of component opening size.

Bay Dividing Wall Between Bays 1 & 2

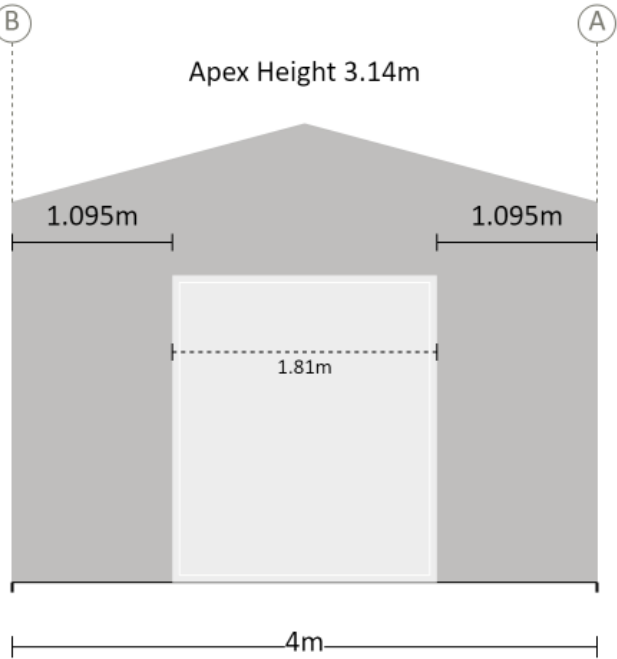

Measurements are from the outside of side girts to the inside of component opening size.

Purchaser Name: Aysha Paddison		Component Position Not to Scale Page 2 of 2 © Copyright Steelx IP Pty Ltd	Seller: The Shed Company Tamworth Cumberland Projects Pty Ltd Phone: 0421 764 928 Fax Email: tamworth@theshedcompany.com.au	Apex Engineering Group PTY LTD ACN 632 588 562 ME Aust. (Registered NER Structural) 5276680 QLD : RPEQ No. 24223; TAS : 185770492; VIC : PE0003848; N.T : 303557ES; Practising Professional Structural & Civil Engineers Signature:  Date: John Ronaldson Date: 25/06/2025
Site Location: 31 Bilga Rd Invergowrie NSW 2350 Australia				
Drawing # TTWH250019 - 10	Print Date: 25/06/2025			

This setout is provided as a guide only. It is the responsibility of the concreter/erector to confirm that all dimensions are correct.

Left Side

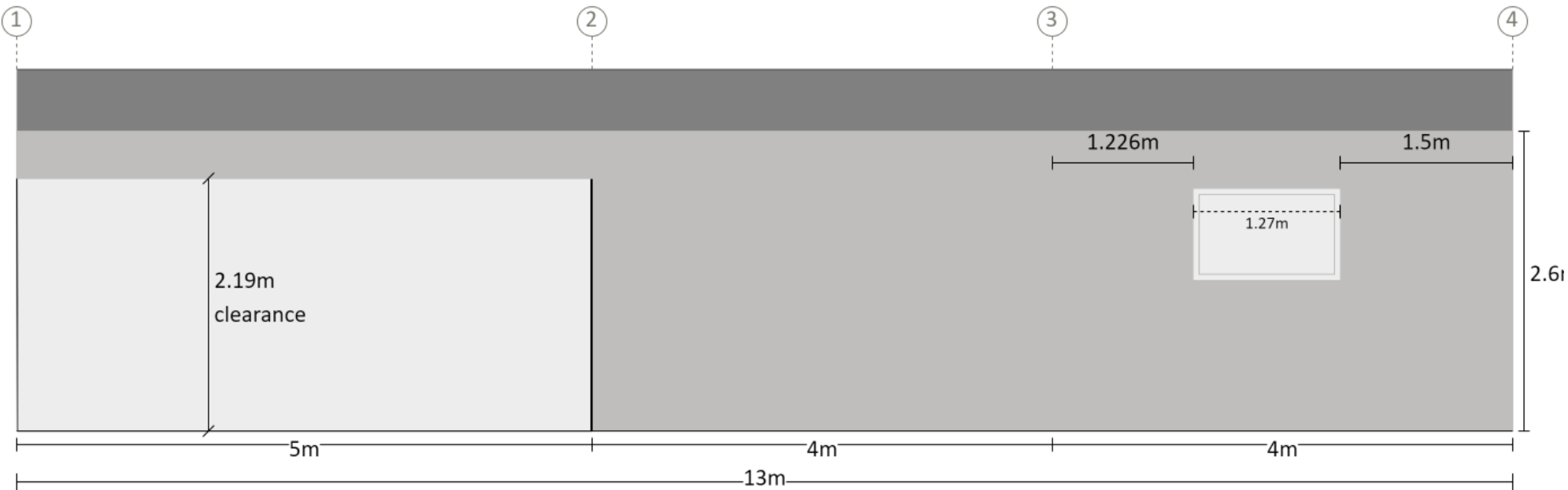

Measurements are from the outside of end girts (end bays) and/or centre of columns (mid bays) to inside of component opening size.

Right Side

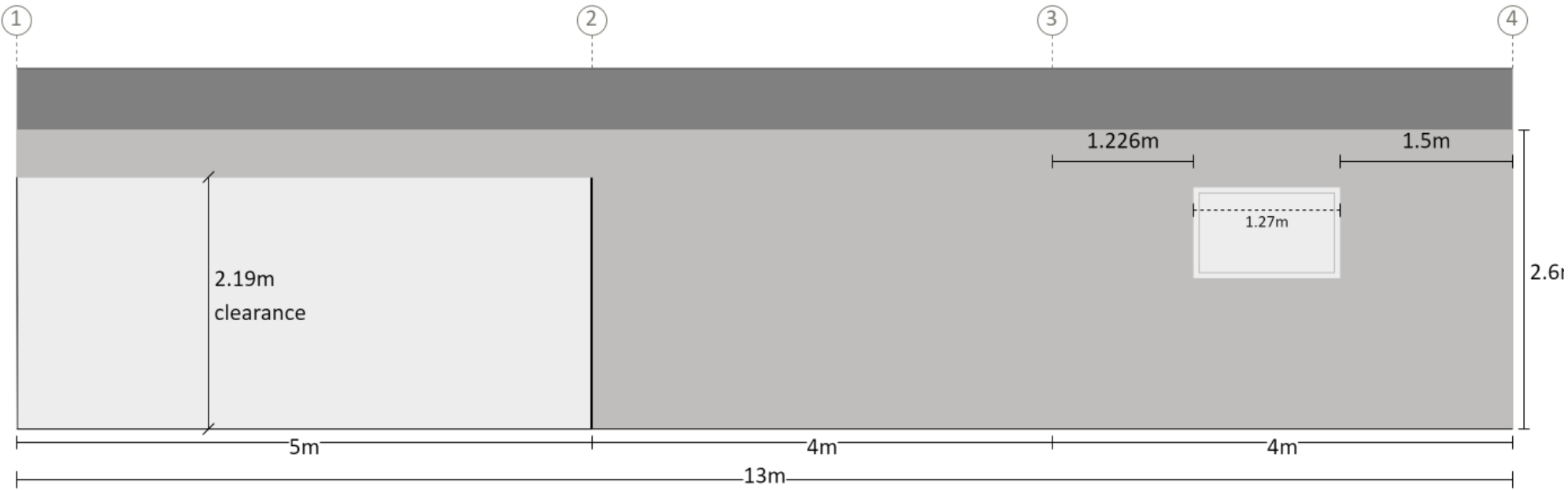

Measurements are from the outside of end girts (end bays) and/or centre of columns (mid bays) to inside of component opening size.

Purchaser Name: Aysha Paddison		<div>Component Position</div> <div>Not to Scale</div> <div>Page 1 of 2</div> <div>© Copyright Steelx IP Pty Ltd</div>	<div>Seller: The Shed Company Tamworth</div> <div>Cumberland Projects Pty Ltd</div> <div>Phone: 0421 764 928</div> <div>Fax</div> <div>Email: tamworth@theshedcompany.com.au</div>	<div>Apex Engineering Group PTY LTD</div> <div>ACN 632 588 562</div> <div>ME Aust. (Registered NER Structural) 5276680</div> <div>QLD : RPEQ No. 24223; TAS : 185770492; VIC : PE0003848; N.T : 303557ES;</div> <div>Practising Professional Structural & Civil Engineers</div> <div>Signature:  Date: John Ronaldson</div> <div>Date: 25/06/2025</div>
Site Location: 31 Bilga Rd Invergowrie NSW 2350 Australia				
Drawing # TTWH250019 - 10	Print Date: 25/06/2025			